

Do Not Write Within Boxed Area.
For Engineering Office Use Only.

CITY OF NAPOLEON
ENGINEERING DEPARTMENT
APPLICATION for SIGN PERMIT

(Please Print or Type)

Owner's Name Schwan's Sales Enterprises, Inc.

Address 635 Independence Drive

Builder Unknown Address _____ Tel _____

Permit No.	<u>00497</u>
Issued	<u>4-5-90</u>
By	<u>FH</u>
Estimated Cost	<u>380.00</u>
Base Fee	<u>5.00</u>
Add	<u>2.56</u>
Total Fee	<u>7.56</u>

SIGN BILLBOARD AWNING MARQUEE

Location of Project: 635 Independence Drive

Additional Information: PEDFIZAC SIGN

Dimensions 4 ft x 8 ft Changeable Copy Square Feet 72

Date 4/5/90

Larry A. Jameson
Signature of Applicant

Application Must Be Accompanied with Sketch and Description of Proposed Installation

Base Fee \$5.00 plus \$.08 Per Sq. Ft. Estimated Cost \$ _____ .00

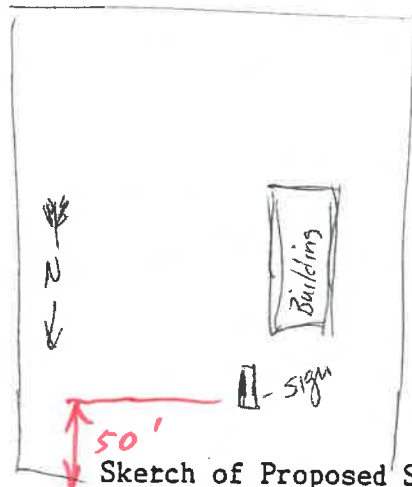
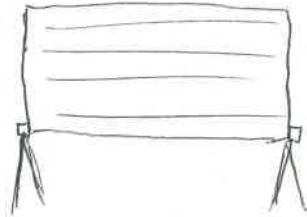

Sketch of Proposed SIGN
also provide a Location Map
on back

Sohwan's Ice Cream

Independence



6" P.U.C.
≈ 6.0'



12" Sanitary

C. B. T. Carter for

9-26-89

Side view

